

GS-ANT-322-5G



Technical Data			
2G, 3G, 4G, 5G - mount (indoor) MiMo & Diversity antenna, desk			
	Frequency Range	698 - 960 MHz 1710 - 3800 MHz	
	Peak Gain	698 - 960 MHz 1710 - 2170 MHz 2200 - 3800 MHz	2.5 dBi 5.0 dBi 4.0 dBi
	Operational bands	2G / 3G / 4G / 5G	
	Typical VSWR	< 2.5 : 1	
	Efficiency	698 - 960 MHz 1710 - 2170 MHz 2200 - 3800 MHz	> 60% > 80% > 50%
	Correlation coefficient	< 0.1	
	Element isolation	> 18 dB	
	Power Max.	20 W	
	Impedance	50 Ω	
	Radiation pattern	Omni-directional	
Mechanical Data			
	Dimensions (HxW)	137 mm x 151 mm	
	Operating temp	-40°C .. +80°C	
	Material	U.V. stable, impact resistant ABS	
	Cable	2 x 2 m, RG174	
	Connector	2 x SMA (m)	
			
	Desk mount, indoor only		
	RoHS compliant		

GS-ANT-322-5G

Typical VSWR Elements 1 & 2

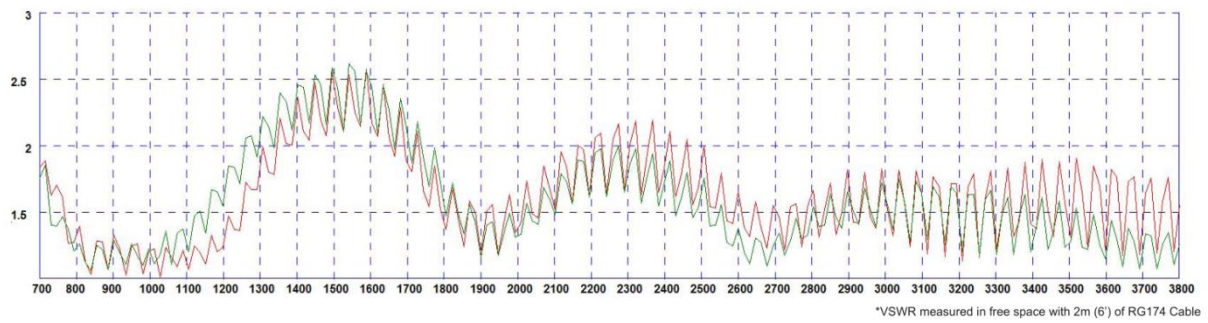

Typical isolation Elements 1 & 2

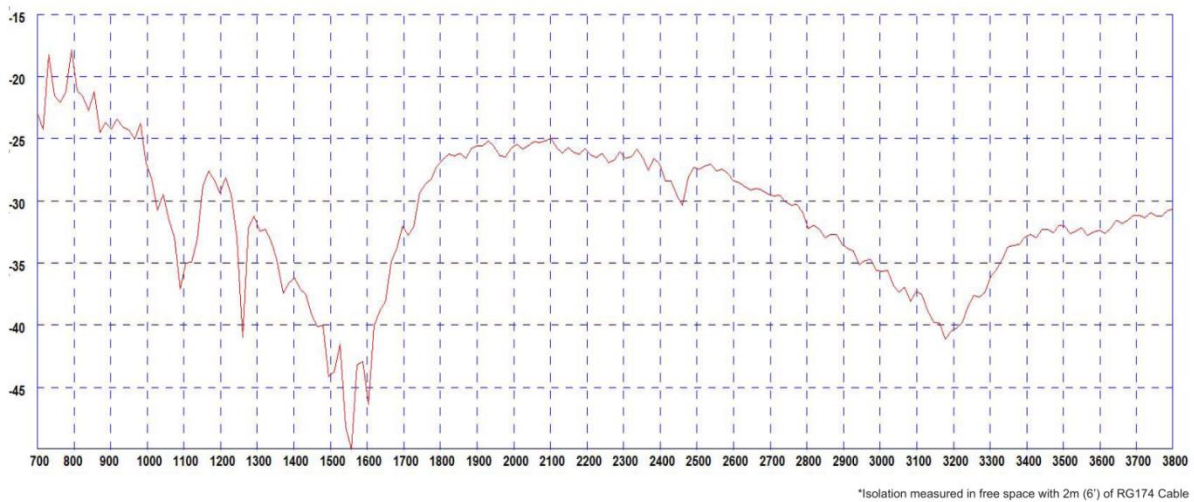

GS-ANT-322-5G

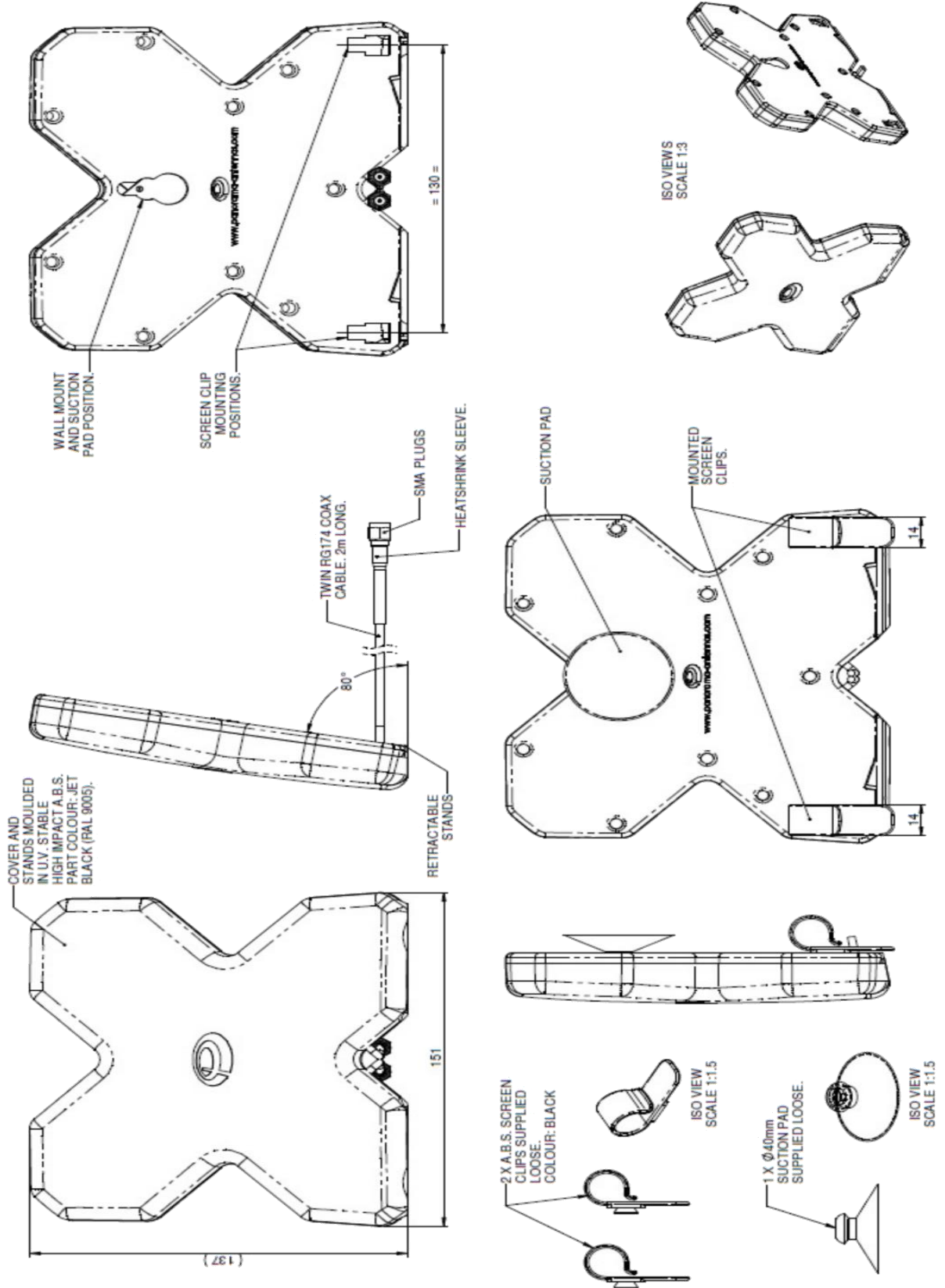

Figure 1; Mechanical drawings